

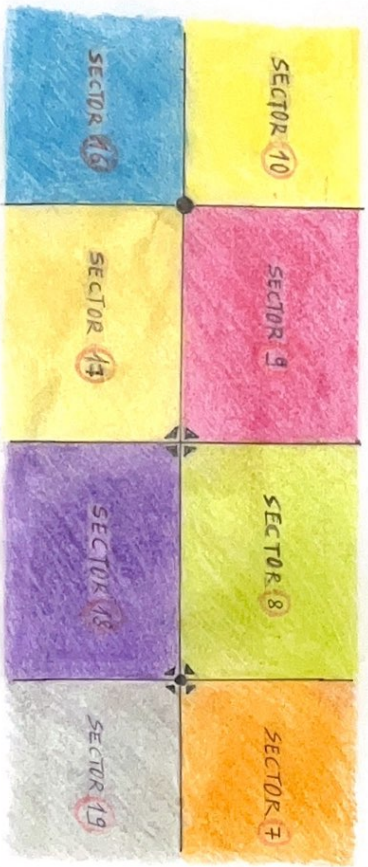

- Legend**
- LEISURE
 - CULTURAL
 - HEALTH
 - OFFICES

ANALYSIS OF SECTORS

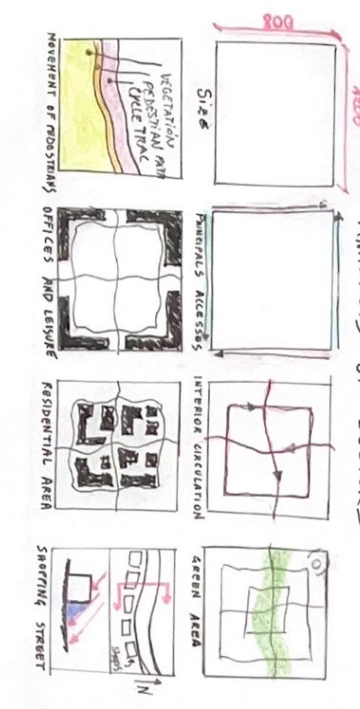

UTOPIA

CHANDIGARH

The city is divided into circular sectors that develop over multiple concentric levels. The outer roads and underground metro connect the various residential areas to each other and to the city center: a park, also in concentric levels, which includes public function buildings.

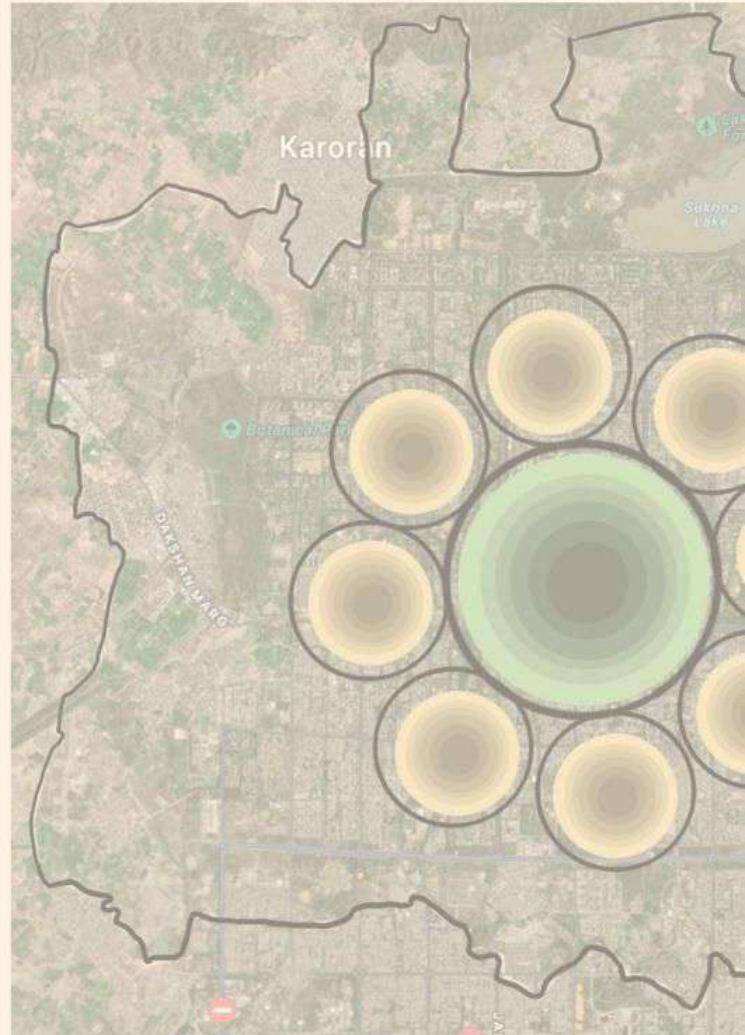

Every small town is self-sufficient, both from a governmental and energy perspective, but still depends on the center. The polycentric system helps from a managerial and social standpoint: communication is facilitated, and the distances between different areas are minimal.

