

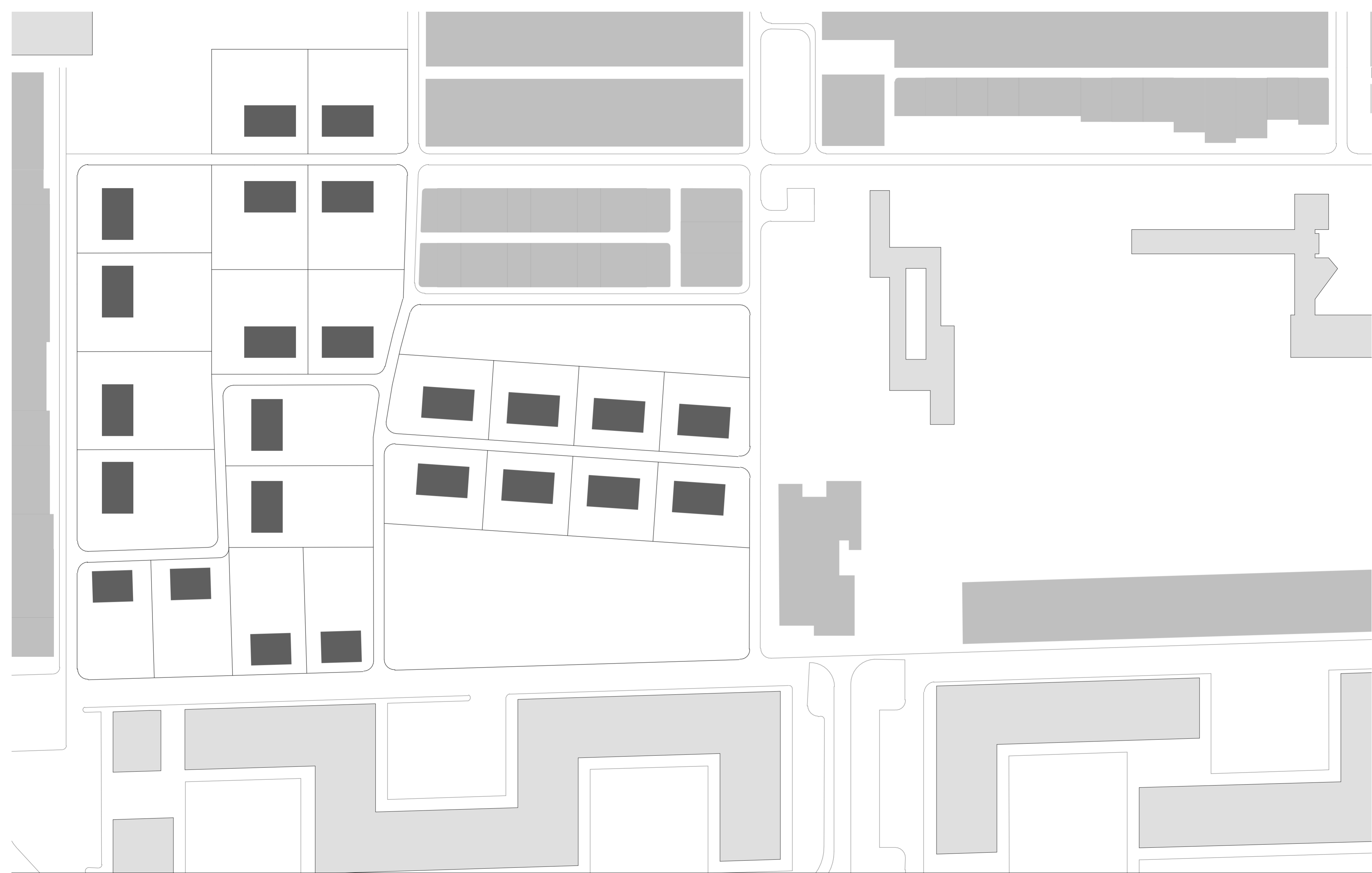

- Public Buildings
- Existing Buildings
- New Single Family Buildings
- New High Density Building (40 Dwelling)

- 1. 60 Dwelling / Ha - Total of 82 New Dwellings
- 2. 30 Dwelling / Ha - Total of 22 New Dwellings
- 3. 100+ Dwelling / Ha - Total of 112 New Dwellings



LOW DENSITY INTERVENTION CHANDIGARH

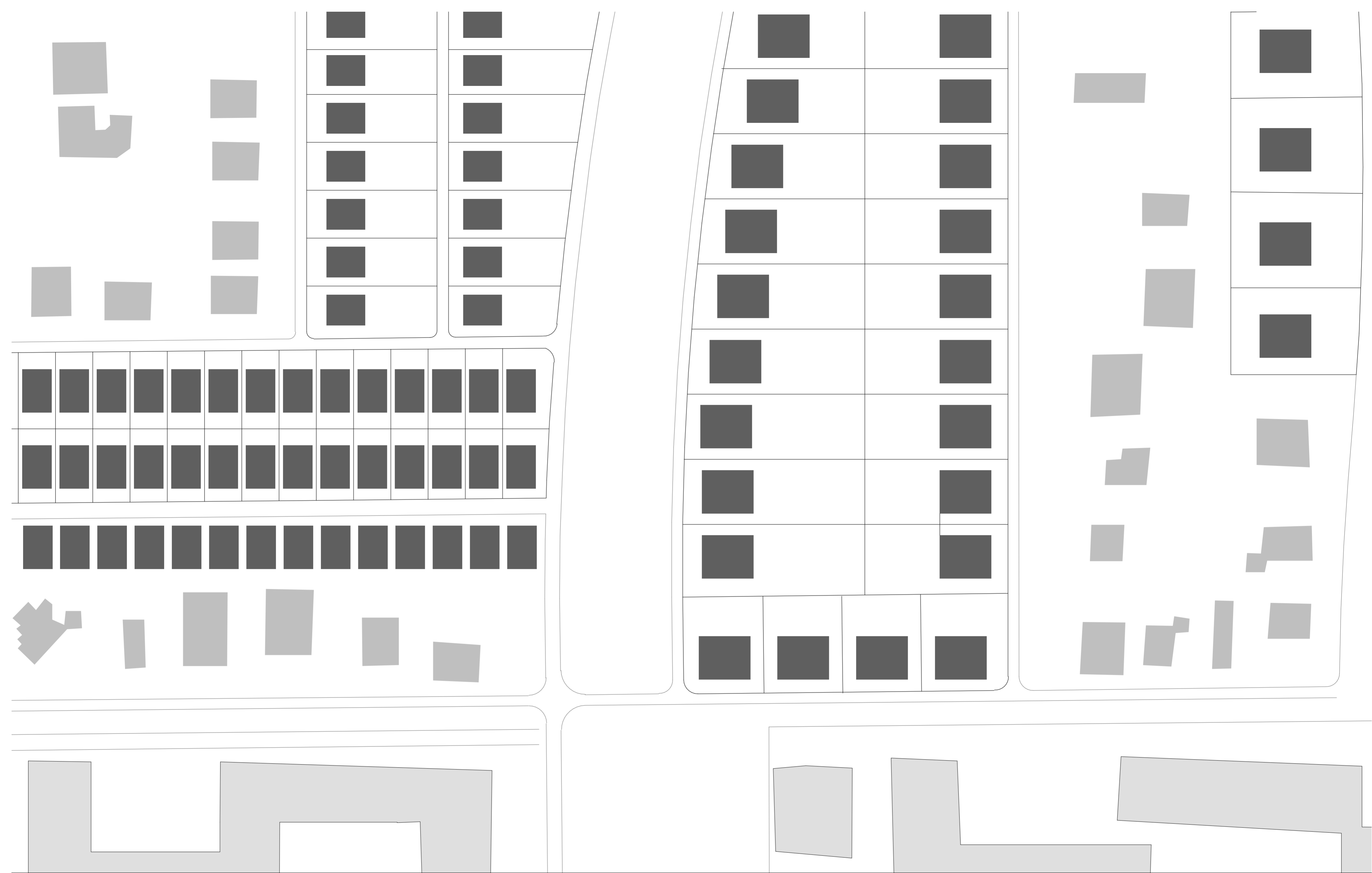

MEDIUM DENSITY INTERVENTION CHANDIGARH

HIGH DENSITY INTERVENTION CHANDIGARH

