

GARTENSTADT, FREIBURG

Alicja Bujas
Emiliana Ciosk
Lucia Sophie

Gartenstadt Freiburg, developed in the early 20th century, embodies the Garden City principles of integrating green spaces and housing to create healthier, community-oriented urban environments. Its layout carefully separates residences from private gardens and public spaces, fostering a balance between privacy and social interaction. The low-rise buildings and cohesive architectural style create a human-scaled, visually harmonious neighborhood. The abundant green spaces enhance environmental sustainability by improving air quality, supporting biodiversity, and managing rainwater. Designed for walkability, the neighborhood connects homes, gardens, and public areas with pedestrian paths and includes cycling routes and public transit access. These features encourage activity and social cohesion, enhancing quality of life by blending privacy with community and urban convenience with environmental care.

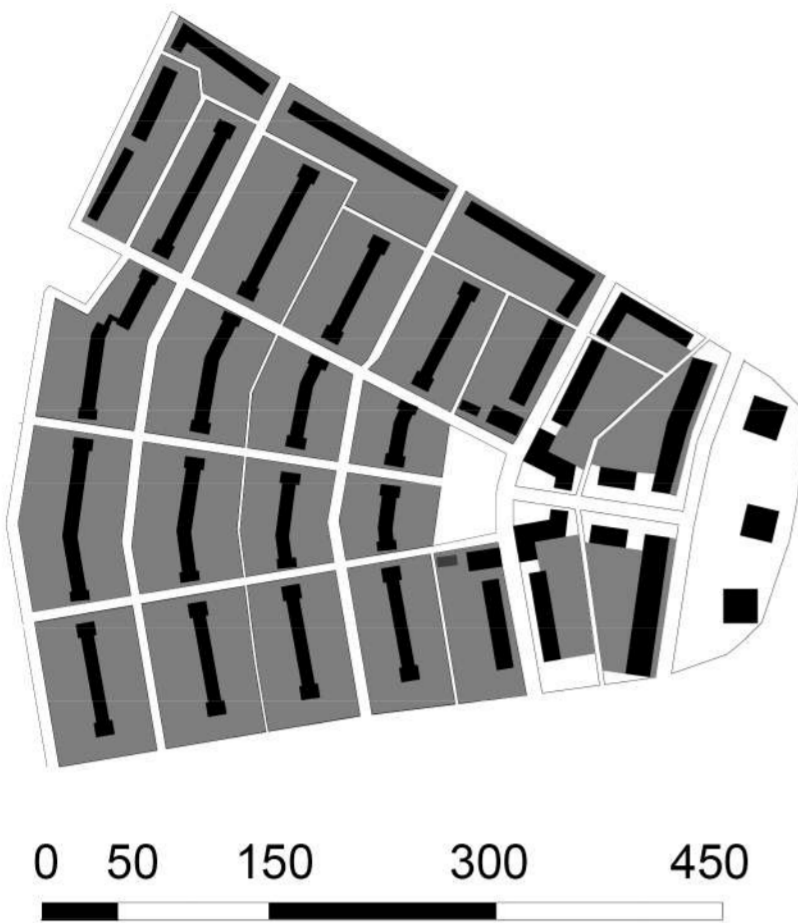

-  public spaces
-  private spaces
-  buildings

A (Base Land Area): 155 540.75 m²
 FSI (Floor Space Index): 0.84
 GSI (Ground Space Index): 0.3
 OSR (Open Space Index): 0.83
 L (Layers): 2.8
 N (Network Density): 0.0219
 W (mesh width) : 91.1
 b (profile width):1.492
 T (Tare): 0.274

